



TABLE TOP KETTLES

TILTING ELECTRIC MODEL TDB

Kettle shall be a Groen Model TDB (specify 20, 24, 40 or 48 quart) stainless steel self-contained steam jacketed unit, operating from an electric heated steam source contained within the unit.

AVAILABLE MODELS:

- ☐ TDB-20 (20 QUART)
- ☐ TDB-24 (24 QUART)
- ☐ TDB-40 (40 QUART)
- ☐ TDB-48 (48 QUART)

CONSTRUCTION: Kettle shall be of 304 stainless steel, one-piece welded construction. All exposed surfaces shall be stainless steel. All controls shall be contained in a gasketed enclosure. Unit shall be furnished with a heavy reinforced rim with a welded-in butterfly shaped pouring lip for maximum sanitation and durability. Right or left hand tilt handle. Faucet bracket is standard and mounted on rear of electrical control box.

FINISH: Interior of kettle shall be polished to a 180 emery grit finish. Exterior of kettle shall be finished to a bright high buff finish, ensuring maximum ease in cleaning and maintaining brilliant appearance.

ASME CODE, AND U.L. LISTING: Unit shall be ASME shop inspected, stamped and registered with the National Board for operation up to a maximum working pressure of 50 PSI. Unit shall be U.L. listed.

SANITATION: Unit shall be designed and constructed to meet NSF and known health department and sanitation codes, and be NSF listed.

SELF-CONTAINED STEAM SOURCE:

Kettle shall have an electrically heated self-contained heat source to provide kettle temperatures of 150°F to approximately 295°F. 20/24 quart models will have 6 or 8 KW input and the 40/48 quart model 12 or 14 KW input, depending on kettle voltage. See reverse for electrical information. Unit shall be factory charged with water and rust inhibitors, to ensure long life and minimum maintenance.

CONTROLS: Controls shall include a thermostat, built in contactor, pressure gauge, front mounted water sight glass and heating indicator lamp.

SAFETY FEATURES: Kettle shall have safety tilt cut-off (cuts off heat when tilted to 12° and above), pressure relief valve, high limit pressure switch and low water cut-off. 24V control system.

PERFORMANCE/FEATURES: Unit shall be thermostatically controlled to automatically shut off when desired temperature is reached and to turn on when product temperature falls below desired setting. Design shall make it possible for one person to tilt kettle, even when kettle is filled to capacity. Pouring height allows filling of 4" high pans on the table top. Tilt handle is field reversible for right or left.

INSTALLATION: Single electrical connection required. Specify 208/240 or 480 Volt, single or three phase. Standard unit shall be shipped 208V / 3Ph and be field convertible from three phase to single phase operation. Remote steam source is not required.

ORIGIN OF MANUFACTURE: Designed and manufactured in the United States.

PROJECT NAME:

LOCATION:

ITEM NO:

QTY:

MODEL NO:

AIA NO:

SIS NO:

Stainless steel 2/3 steam jacketed kettle, table top, tilting, self-contained, electric heated 20,24,40 and 48-quart capacity.



OPTIONS/ACCESSORIES:

- ☐ Etch marks, gallons
- ☐ Etch marks, liters
- ☐ Correctional package
- ☐ 316 s/s liner
- ☐ Single pantry faucet
- ☐ Double pantry faucet
- ☐ Single pantry pre-rinse
- ☐ Double pantry pre-rinse
- ☐ Basket insert
- ☐ Nylon basket liner
- ☐ Liner retaining ring
- ☐ Lift off cover
- ☐ Cover holder
- ☐ Cover strainer
- ☐ Stand
- ☐ Drain cart
- ☐ Cart plumbing kit

Table Top Kettles
143946 RevE
Revised 06/15

TABLE OF DIMENSIONS											
MODEL	TDB-20		TDB-24		TDB-40		TDB-48				
DIM	INCH	MM	INCH	MM	INCH	MM	INCH	MM	INCH	MM	
A	14	356	14	356	16.5	419	16.5	419	16.5	419	
B	17.6	447	17.6	447	19.2	488	19.2	488	19.2	488	
C	24	610	24	610	28.0	711	28.0	711	28.0	711	
D	20.8	528	20.8	528	22.4	569	22.4	569	22.4	569	
F	23.1	587	24.6	625	25.1	632	27.3	693			
H	25.6	650	25.6	650	28.0	711	28.0	711			
J	15.5	394	16.0	406	18.5	470	19.0	483			
K	3.5	89	5.0	127	7.5	191	9.8	249			
L	5.5	140	5.5	140	4.3	109	4.3	109			

ELECTRICAL REQUIREMENTS TABLE					
KETTLE MODEL	TDB-20 & 24	TDB-40 & 48			
VOLTS	PHASE	KW	AMPS	KW	AMPS
208	1	6.3	31	10.8	52
	3		18		30
240	1	8.4	35	14.4	60
	3		20		35
440	3	6.3	8	12.0	15
	3		8		15

SERVICE CONNECTIONS AND NOTES:

- ① ELECTRICAL SUPPLY: 3/4" WATER RESISTANT CONDUIT (1" FOR 240V, 1 PHASE)
- ② DIMENSIONS IN BRACKETS [] ARE MM.
- ③ MAXIMUM WIDTH - TDB 20/24 IS 25 3/4" AND TDB-40/48 IS 28"



P/N 137837 REV E

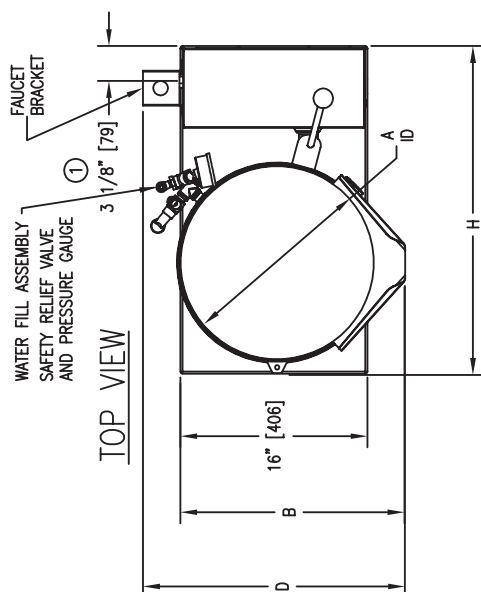

MAXIMUM WIDTH
SEE NOTE #3

