



BEVERAGE-AIR

Project: _____	AIA#
Item: _____	
Location: _____	SIS#
Approved: _____	

ST SCHOOL MILK COOLERS

ST34N Dual Access, Cold Wall

MODELS:
ST34N-1-W

ST34N Dual Access, Cold Wall : School Milk Series



ST34N -1-W

3 Year Parts/Labor Warranty
Additional 2 Year Compressor Warranty

CABINET CONSTRUCTION

- White coated steel exterior
- Interior is galvanized steel with stainless steel floor for maximum milk crate support.
- Lids, doors, adjustable hinges and door latches made from stainless steel are standard on all units
- Full electronic Control
- Heavy-duty epoxy coated steel wire floor racks standard
- Floor drain is centrally located for easy cleaning, connecting to drain hose with hose adapter
- Flexible compression door gaskets ensure tight seal
- Self-latching doors/lids with safety bumpers
- Exterior thermometer
- Cylinder lock
- 4" Heavy-duty plate casters (2 with locks)
- Dual access, cold wall milk coolers are designed to hold milk between 36°F to 38°F until ready to serve.
- Units are not designed for overnight storage of milk

OPTIONS & ACCESSORIES

- Stainless steel exterior
- Stainless steel interior
- Wrap around & corner bumpers
- Graphics

REFRIGERATION SYSTEM

- Refrigeration system uses R404A refrigerant to comply with all environmental concerns
- Automatic non-electric defrost
- Epoxy coated evaporator coil



3779 Champion Blvd., Winston-Salem, NC 27105
1-888-845-9800 Fax: 1-336-245-6453
Beverage-Air.com sales@bevair.com



BEVERAGE-AIR

ST Series—School Milk Cooler

Models: ST34N-1-W

MODEL	ST34N-1-W
EXTERNAL DIMENSIONAL DATA	
Width Overall	34"
Depth Overall	31 1/4"
Depth Overall with Lids/Doors Extended	61"
Height Overall with Casters	41 1/8"
Number of Lids/Doors	4
INTERNAL DIMENSIONAL DATA	
NET Capacity (cubic ft.)	13.6
Internal Width Overall (in)	31"
Internal Depth Overall (in)	27"
Internal Height Overall (in)	25 1/2"
CASE CAPACITIES	
13" x 13" x 11"	8
19" x 13" x 11"	4
ELECTRICAL DATA	
Full Load Amperes 115/60/1	4.0
REFRIGERATION DATA	
Horsepower	1/4
WEIGHT DATA	
Gross Weight (Crated lbs)	267 lbs
Height - Crated	47"
Width - Crated	37"
Depth - Crated	34"

Note: Unit is not meant for overnight storage.

Model Views

Plan View

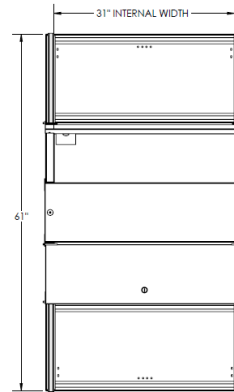

Elevation View

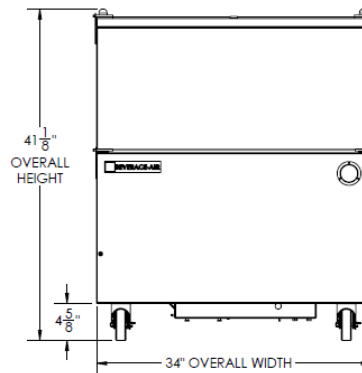

Side View

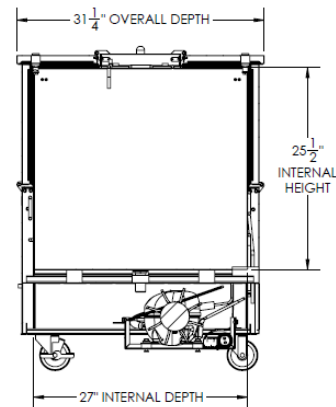

ELECTRICAL CONNECTION

Units pre-wired at factory and include 8' long cord and plug set.



115/60/1
NEMA-5-15P



an Ali Group Company



3779 Champion Blvd., Winston-Salem, NC 27105
1-888-845-9800 Fax: 1-336-245-6453
Beverage-Air.com sales@bevair.com